



Wide range of pressure and flow options

True stepless control and low noise operation

Long trouble free cycle life

Minimal set up time

High stable working closed loop system

PROPORTIONAL ADVANTAGE



PROPORTIONAL **EXPERTISE**



PROPORTIONAL CONTROL IS ESSENTIAL WHEN YOU NEED THE FLEXIBILITY TO CONTROL THE OUTPUT PRESSURE OR FLOW IN AN APPLICATION. THIS CAN BE ACHIEVED WITH SIMPLE PROGRAMMING STEPS.

COMBINING THE PROVEN TECHNOLOGIES OF ITS WATSON SMITH AND HERION SERIES NORGREN OFFERS UNRIVALLED EXPERTISE TO FIND THE RIGHT SOLUTION FOR YOU.

CHOOSE FROM OUR EXTENSIVE RANGE OF PROPORTIONAL VALVES. ANALOGUE AND DIGITAL, OPEN OR CLOSED LOOP, FLOW OR PRESSURE CONTROL.

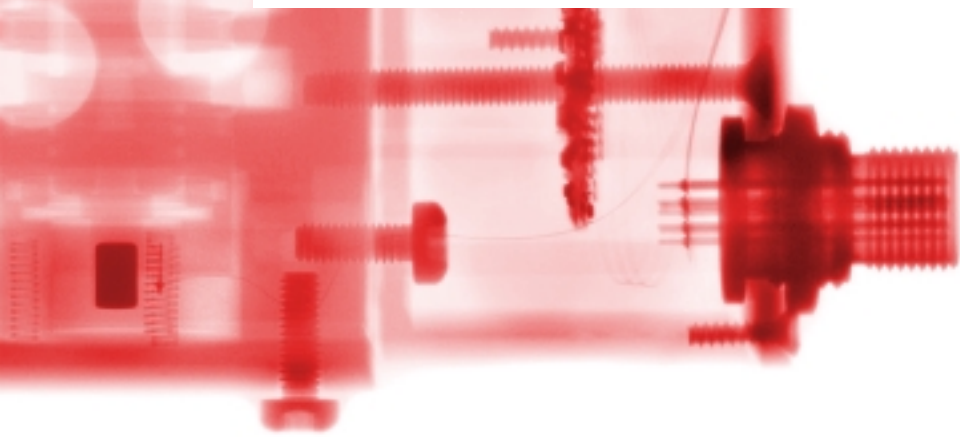

- » COMPREHENSIVE RANGE TO MEET ALL APPLICATION REQUIREMENTS
- » SMOOTH STEPLESS RESPONSE FOR BETTER RESOLUTION
- » QUIET AND RELIABLE DUE TO PILOT VALVE OPERATION
- » HIGHLY CONFIGURABLE FOR APPLICATION SPECIFIC REQUIREMENTS
- » SHORT SET UP TIME TO INCREASE PRODUCTIVITY
- » DIGITAL ELECTRONICS OFFERS MULTIPLE INTERFACE POSSIBILITIES

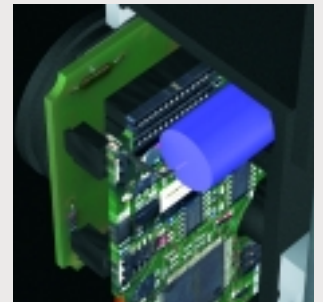
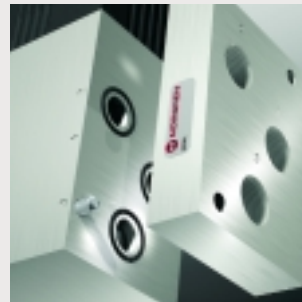
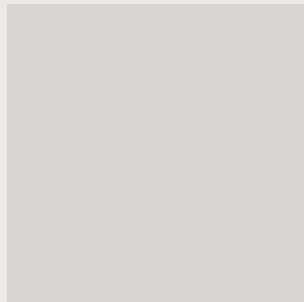
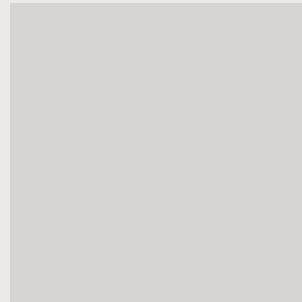
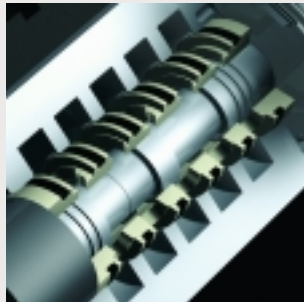

The new Norgren pressure and flow control proportional valves incorporate advanced spool and balanced-poppet technologies. Unlike competitive products which rely upon miniature snap-action seats, our valves provide true stepless pressure or flow control. The result is smooth response, low noise, and a long trouble-free cycle life.

On-board digital electronics assure maximum flexibility and ease of tuning for specific application conditions. Self diagnostics, optional digital displays, and a variety of Fieldbus interfaces are all benefits of the microprocessor-based design.

Precise closed-loop performance is achieved via internal pressure feedback (pressure control valves), or spool position feedback (flow control valves).

NORGREN ADVANTAGE

PRESSURE CONTROL APPLICATION EXAMPLES

Spot Welding, Material Thickness Control, Brake Pressure Control, Tyre Production, Concrete Moulding, Leak Detection, Blow Moulding, Polishing & Grinding, Vacuum Forming, Stress Testing, Ultrasonic Welding, Pressure Gauge Calibration, Tension Control, Textile Fabrication, Coil Winding, Paper Tensioning, Carriage Movement, Dosing, Material Finishing, Paint Spraying etc.

SPOT WELDING

- » RESPONSE SPEED
- » REPEATABILITY

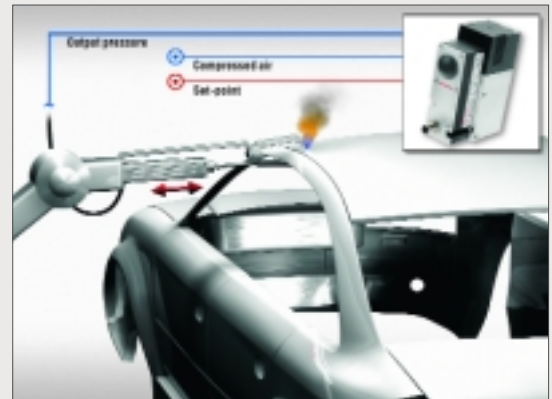

TENSION CONTROL

- » RESOLUTION
- » TRUE STEPLESS CONTROL

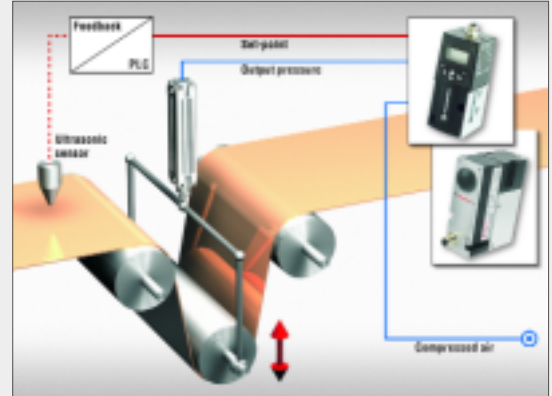

LEAK TESTING

- » REPEATABILITY
- » DYNAMIC RESPONSE CHARACTERISTIC



FLOW CONTROL APPLICATION EXAMPLES

Cylinder Motion Control, Paint Spraying, Volume Control, Filling Systems, Positioning, Vacuum Generation, Heat Exchanger.

POSITIONING

- >> STABILITY
- >> DIFFERENT UNITS REPEATABILITY OF CONTROL

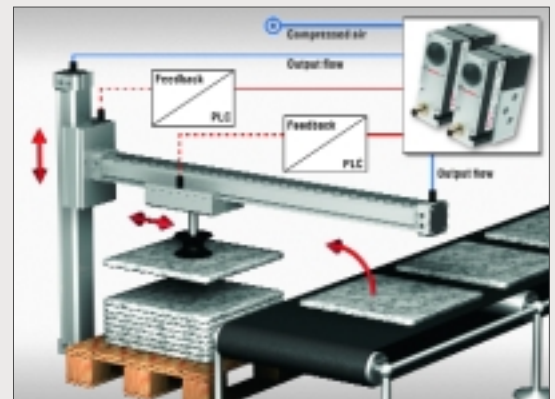

TORQUE AND SPEED CONTROL

- >> RESPONSE TIME
- >> STABILITY

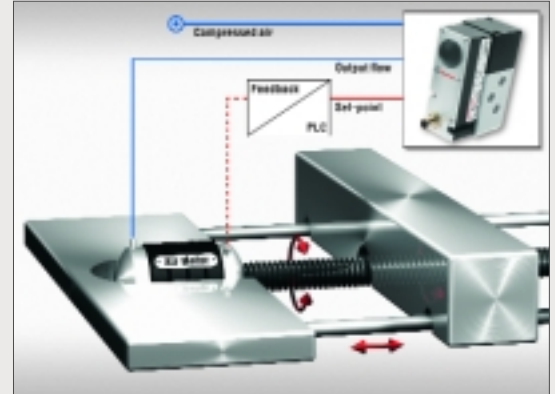

With Norgren digital control valves, the user can make adjustments to critical parameters such as pressure range, offset, and response time, thus allowing maximum flexibility to suit a broad range of application requirements.

Microcontroller based control electronics permits data transfer with interfaces such as ASI, Profibus and DeviceNet, with the flexibility for further future terminal configurations such as CAN. This offers many advanced features including self-diagnosis and flow linearisation.

In all basic valve versions, tuning is accomplished either through simple potentiometer adjustments or menu-driven programming from the front panel keypad/display. With most versions an optional RS-232 serial port permits downloading of calibration parameters from a PC to the valve.

This saves set up time and assures consistent unit-to-unit performance in OEM applications.

The breadth of Norgren's new proportional range ensures maximum choice for critical application factors such as: low power, low air consumption, unlubricated, lubricated medium, flow rates up to 3,500l/min (40 SCFM), and pressure ranges from 0 - 16 bar (230psi).

A wider range of flows, pressures and control options to cover all your application requirements are available on request.

VP21 PRESSURE CONTROL

The VP21 3-way proportional pressure regulator is a poppet valve with closed loop pressure regulation and integrated digital electronics.

HIGH FUNCTIONALITY

- [01] ALL UNITS INCLUDE AN ELECTRONIC BOARD WITH STATUS LED FOR FAST DIAGNOSTIC
- [02] WIDE RANGE OF STANDARD PRESSURE OUTPUT (2 BAR, 10 BAR, 16 BAR)
- [03] POPPET VALVE DESIGN FOR LONG TROUBLE FREE CYCLE LIFE (LOW FRICTION)
- [04] EASY CONFIGURABLE FOR CUSTOMER APPLICATION

HIGH PERFORMANCE

- >> HIGH REPETITION ACCURACY [$\leq 0,5\%$ P MAX.] ASSURES HIGH PRODUCTION QUALITY
- >> FAST AND STABLE RESPONSE FOR HIGH DEMANDING
- >> HIGH OPERATING PRESSURE MAX. 18 BAR (261 PSI)

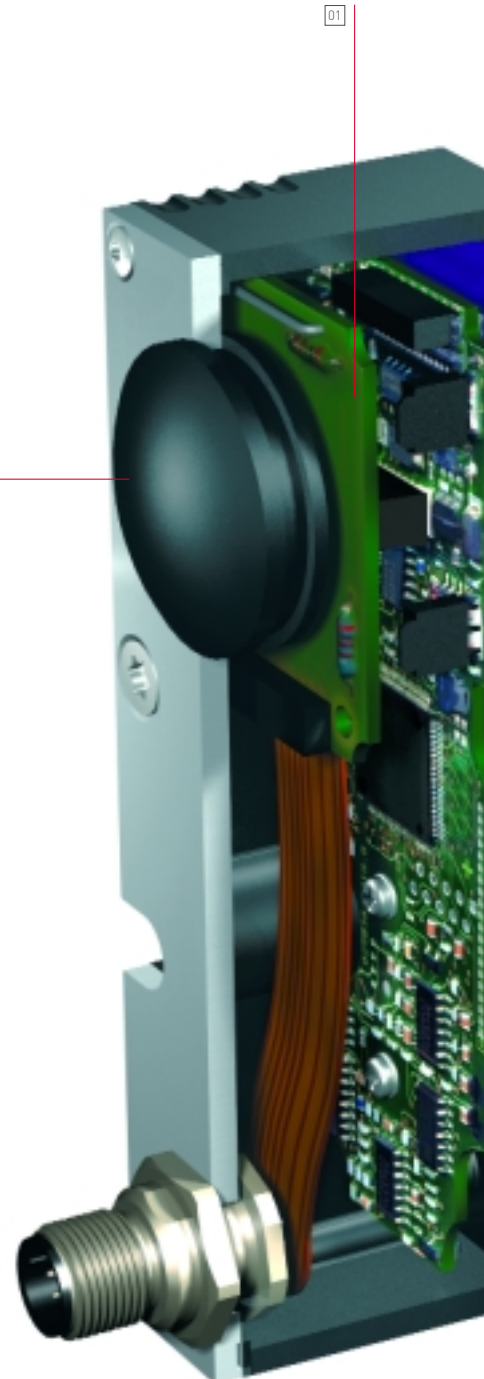

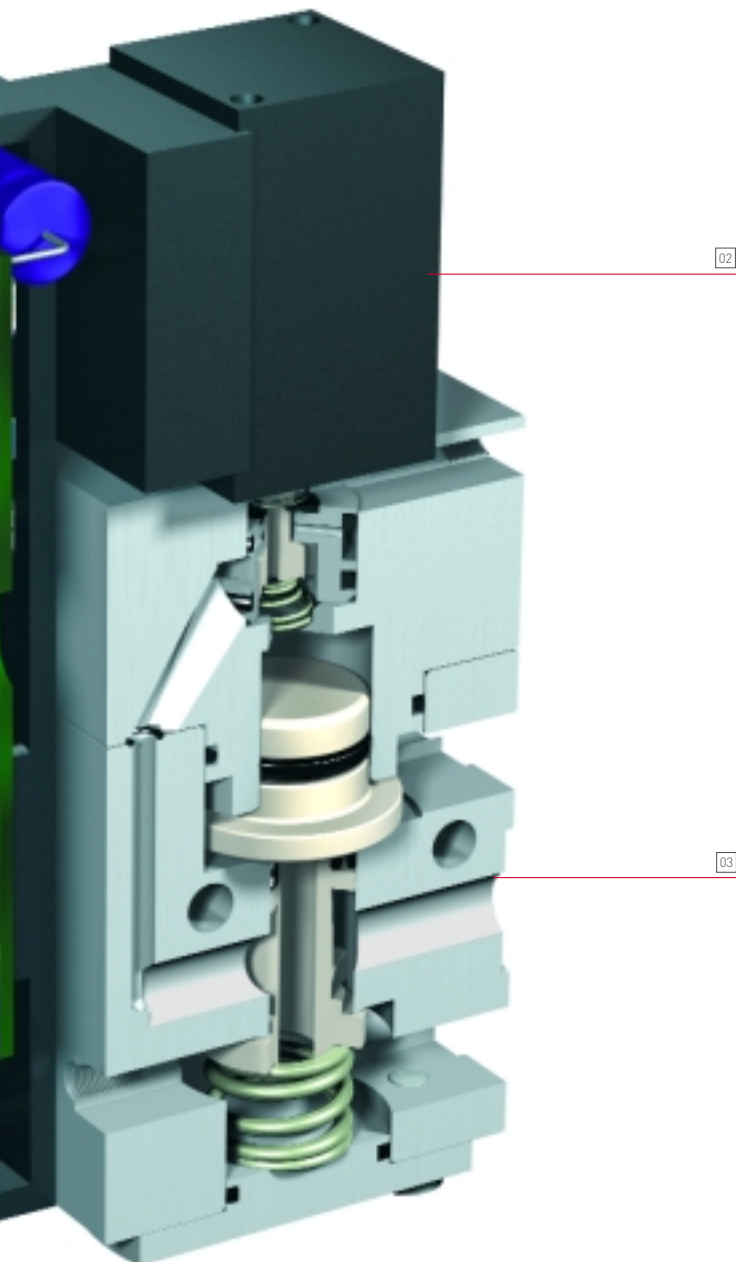

- >> **FLOW**
 SIZE 8MM FLOW PATH 3,500 L/MIN [125 SCFM]
 SIZE 16MM FLOW PATH 15,000 L/MIN [535 SCFM]
- >> **OUTPUT PRESSURE RANGE**
 0 - 2BAR (30PSI)
 0 - 10BAR (145PSI)
 0 - 16 BAR (230PSI)
- >> **FILTER**
 50 μ M FILTERED UNLUBRICATED AND
 LUBRICATED COMPRESSED AIR
- >> **PORT SIZES (SUBPLATE):**
 SIZE 8MM G & NPT 1/4", 3/8"
 SIZE 16MM G & NPT 1/2", 3/4"
- >> **SILICONE (LABS) FREE**
 (FOR USE IN AUTOMOTIVE PLANTS)

>> STANDARD VERSION

VP50/1 PRESSURE CONTROL

The VP50/1 is a 3-way pressure regulator that uses an air piloted glandless spool integrated with an accurate pressure close loop control.

Standard digital control for the VP51

HIGH FUNCTIONALITY

- >> HIGHLY CONFIGURABLE FOR CUSTOMER APPLICATION
- [01] MENU DRIVEN DISPLAY AND KEYPAD FOR USER-SPECIFIC PROGRAMMING (VP51)
- [02] GREEN AND RED LED FOR EASIER VISUAL DIAGNOSTICS AND CONTROL (VP51)
- >> REAL TIME DIAGNOSTICS AND PRESSURE INDICATION AND CONTROL SIGNAL (VP51)
- [03] MENU DRIVEN DISPLAY AND KEYPAD FOR USER-SPECIFIC PROGRAMMING (VP51)
- >> ISO II MANIFOLD OPTION AVAILABLE

HIGH PERFORMANCE

- >> EXCELLENT CONTROL RESOLUTION
- >> REAL TIME DIAGNOSTICS AND PRESSURE INDICATION (VP51)
- >> FAST STEP RESPONSE FOR INCREASED PRODUCTIVITY
- [04] LOW POWER CONSUMPTION. LESS THAN 1W (PILOTED SYSTEM)
- >> HIGHLY ACCURATE, WITH TOTAL ERROR BEING LESS THAN 1% OF TOTAL SPAN
- >> VERY LOW REPETITION ERROR $\leq 0.5\%$ OF TOTAL SPAN

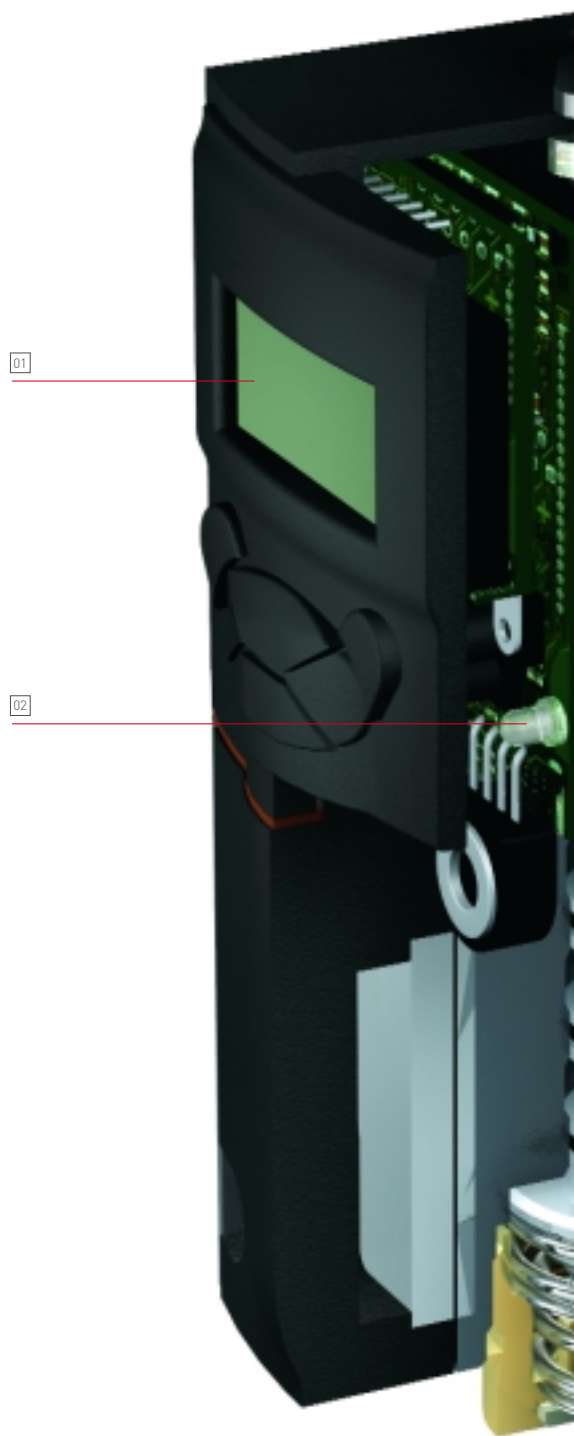

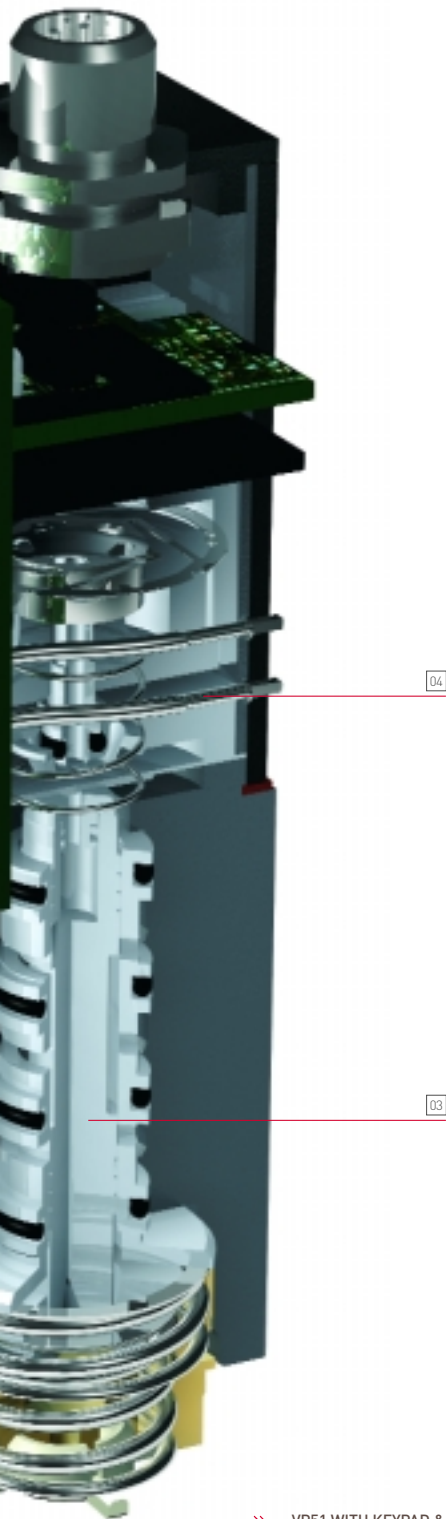

>> VP51 WITH KEYPAD & LCD DISPLAY SHOWN

- >> **FLOW**
SIZE 4MM FLOW PATH : 1,300L/MIN MAX (45 SCFM)
- >> **OUTPUT PRESSURE RANGE**
0 - 2BAR (30PSI)
0 - 6BAR (90PSI)
0 - 10 BAR (145PSI)
- >> **FILTER**
5 MICRONS FILTERED UNLUBRICATED
COMPRESSED AIR
- >> **PORT SIZES**
G & NPT: 1/4"
- >> **OPERATING TEMPERATURE**
-5° TO 50°C

VERSIONS AVAILABLE



>> VP50 ANALOGUE VALVE



>> VP51 DIGITAL VALVE



>> VP51 DIGITAL VALVE
WITH DEVICE NET

(All versions available in size 4mm)

VP60 FLOW CONTROL

This 5/3 Way proportional flow control valve is a direct operated spool valve with micro-controlled position feedback and integrated digital electronics.

HIGH FUNCTIONALITY

- 01 ALL UNITS INCLUDE A DIGITAL ELECTRONIC BOARD WITH STATUS LED FOR FAST DIAGNOSTIC PLANNED OPTIONS: FIELDBUS, ALL PORTS BLOCKED, FLANGE VERSION
- 02 DIRECT DRIVEN SYSTEM FOR HIGH DYNAMIC DEMANDS
- 03 SPECIAL COATED GLANDLESS SPOOL DESIGN FOR HIGH RELIABILITY
- 04 EASY CONFIGURABLE FOR CUSTOMER APPLICATION SERIAL INTERFACE FOR USER SPECIFIC PROGRAMMING (OPTION)

HIGH PERFORMANCE

- >> HIGH ACCURACY [$\leq 1\%$ MAX. STROKE] ACHIEVED WITH INTERNAL PRECISE SLIDE POSITION CONTROL
- >> BI - DIRECTIONAL FLOW CONTROL
- >> FAST AND STABLE RESPONSE [RISE TIME 5MS WITH 100% AMPLITUDE]
- >> HIGH OPERATING PRESSURE MAX. 12 BAR (174 PSI)
- >> PLANNED OPTIONS: SECOND LOOP CONTROL (SPEED, POSITION, PRESSURE, EXT. FLOW)

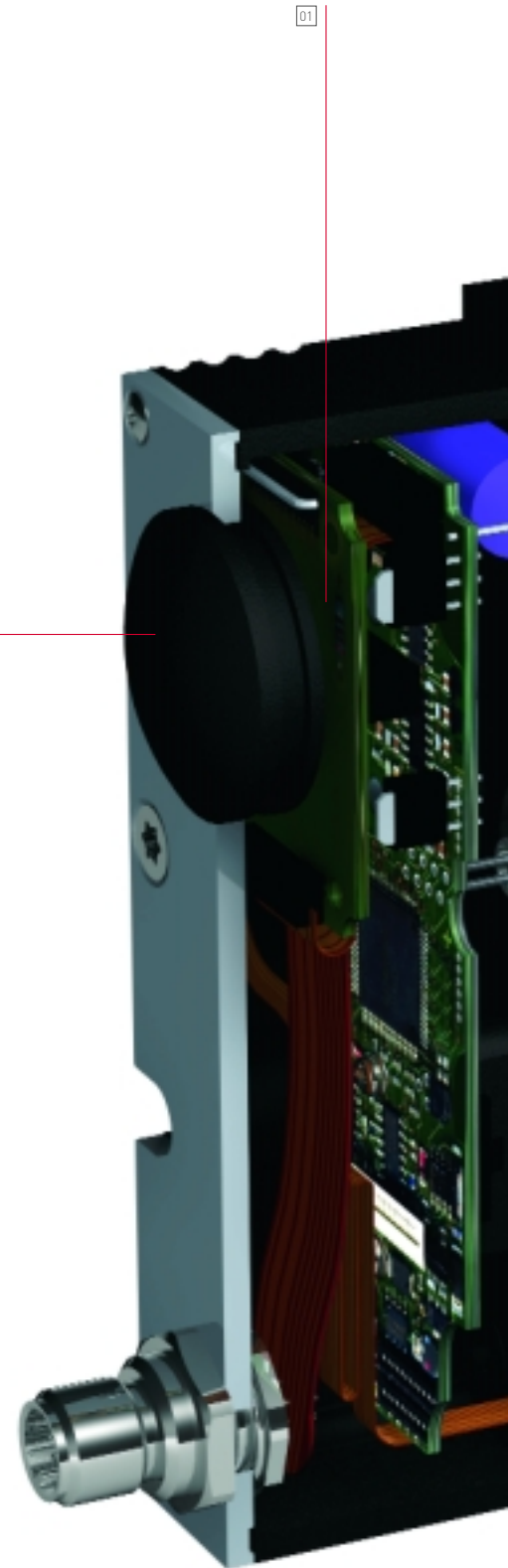

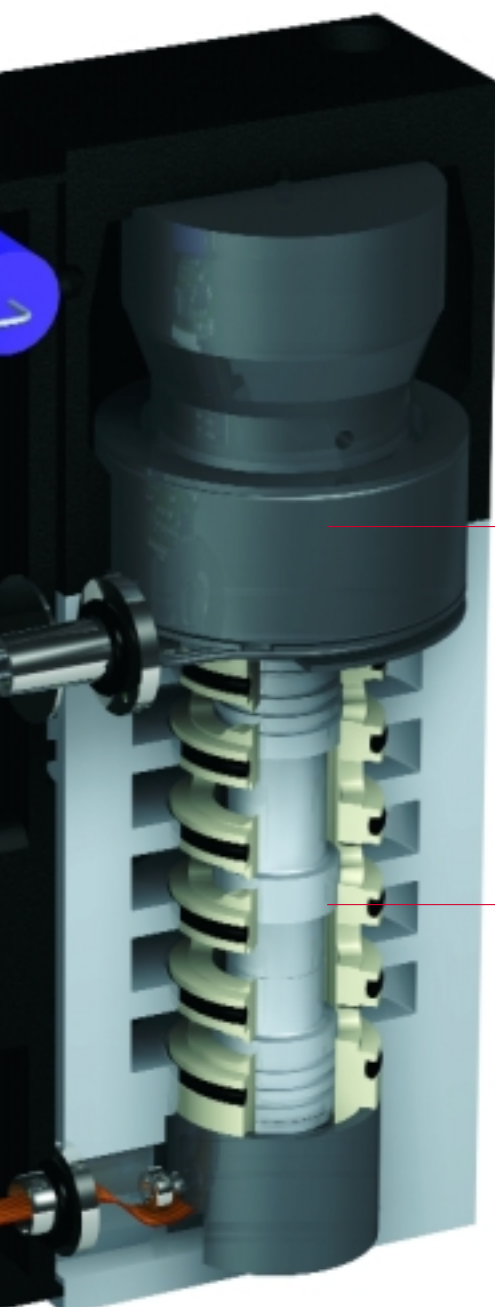

02

03

- >> **FLOW**
SIZE 8MM FLOW PATH: MAX OUTPUT FLOW RATE
3600L/MIN (40 SCFM)
- >> **FILTER**
5 μ M FILTERED UNLUBRICATED AND
LUBRICATED COMPRESSED AIR
- >> **PORT SIZES**
G & NPT: 1/4" (ISO2 AVAILABLE ON REQUEST)
- >> **SILICONE (LABS) FREE**
(FOR USE IN AUTOMOTIVE PLANTS)

VERSIONS AVAILABLE



- >> STANDARD WITH MINI KEYPAD
AND STATUS LED



- >> SERIAL INTERFACE AND
OPTIONAL LED DISPLAY

(All versions available in size 8mm)

- >> STANDARD OPTION WITH MINI KEYPAD SHOWN

AUSTRALIA

Tel: +61 3 921 30 800
 Fax: +61 3 921 30 890
 enquiry@norgren.com.au

AUSTRIA

Tel: +43 22 36 63 520
 Fax: +43 22 36 63 520 20
 enquiry@at.norgren.com

BELGIUM & LUXEMBURG

Tel: +32 2 376 60 20
 Fax: +32 2 376 26 34
 enquiry@be.norgren.com

BRAZIL

Tel: +55 11 5698 4000
 Fax: +55 11 5698 4001
 vendas@norgren.com.br

CHINA

Tel: +86 21 64 85 69 09
 Fax: +86 21 64 95 60 42
 norgren@online.sh.cn

CZECH REPUBLIC

Tel: +420 465 612 879
 Fax: +420 465 612 908
 enquiry@cz.norgren.com

DENMARK

Tel: +45 44 91 41 66
 Fax: +45 44 91 15 60
 norgren@norgren.dk

FINLAND

Tel: +358 95 712 140
 Fax: +358 95 712 1440
 arki@imi-norgren.fi

FRANCE

Tel: +33 1 60 05 92 12
 Fax: +33 1 60 06 08 52
 norgren@norgren.fr

GERMANY

Tel: +49 2802 49-0
 Fax: +49 2802 49356
 info@norgren.de

HONG KONG

Tel: +852 2492 7608
 Fax: +852 2498 5878
 enquiry@hk.norgren.com

HUNGARY

Tel: +36 1 284 9000
 Fax: +36 1 284 8980
 info@norgren.hu

INDIA

Tel: +91 11 2681 7933
 Fax: +91 11 2681 7932
 enquiry@norgren.co.in.

IRELAND

Tel: +353 1 8300 288
 Fax: +353 1 8300 082
 norgren@indigo.ie

ITALY

Tel: +39 039 60 631
 Fax: +39 039 60 63 301
 d.aziendale@norgrenitalia.it

JAPAN

Tel: +81 6 6876 8913
 Fax: +81 6 6876 8929
 Japan@imi-norgren.com

MALAYSIA

Tel: +60 3 5121 9255
 Fax: +60 3 5121 2889
 enquiry@norgren.com.my

MEXICO

Tel: +52 55 5565 7521
 Fax: +52 55 5565 7072
 neumatica@norgren.com.mx

NETHERLANDS

Tel: +31 20 6822751
 Fax: +31 20 6820983
 enquiry@nl.norgren.com

NEW ZEALAND

Tel: +64 9 579 0189
 Fax: +64 9 526 3398
 enquiry@nz.norgren.co.nz

NORWAY

Tel: +47 67 90 82 01
 Fax: +47 67 97 06 24
 norgren@norgren.no

POLAND

Tel: +48 22 871 7880
 Fax: +48 22 871 7881
 biuro@pl.norgren.com

SINGAPORE

Tel: +65 6862 1811
 Fax: +65 6862 1916/17
 enquiry@sng.norgren.com

SLOVENIA

Tel: +386 4 531 7550
 Fax: +386 4 531 7555
 info@si.norgren.com

SPAIN

Tel: +34 93 748 9800
 Fax: +34 93 783 0838
 norgren@norgren.es

SWEDEN

Tel: +46 40 59 51 00
 Fax: +46 40 49 50 90
 info@norgren.se

SWITZERLAND

Tel: +41 71 973 82 00
 Fax: +41 71 973 82 01
 norgren@norgren.ch

UK

Tel: +44 1543 265 000
 Fax: +44 1543 265 811
 enquiry@uk.norgren.com

USA

Tel: +1 303 794 2611
 Fax: +1 303 795 9487
 inquiry@usa.norgren.com

Supported by distributors worldwide

www.norgren.com

The Roundel, 'Norgren' and 'IMI' are registered trade marks
 © IMI Norgren Limited 2004.
 Due to our policy of continuous development, Norgren reserve the right to change specifications without prior notice.

z6707_IPS UK 12/04